

# PROCONTROL<sup>®</sup>

## KP-1600E-K-PC IP65 Touchscreen-operated industrial PC



The KP-1600E-K-PC industrial PC has been developed for manufacturers, industrial plants, factories. It can be used for production management, process monitoring and control purposes. The PC has IP65 rated, stainless alloy steel, tight case, thus it is able to operate in harsh, humid environmental conditions.

KP-1600E-K-PC is KP-1600E industrial monitor with (-K, for) capacitive touch screen and (-PC for) built-in PC.

### Structure

The device consists of two main pieces:

- Monitor case with built-in 19" high-resolution monitor and touch panel
- Computer case with built-in industrial PC and power unit

The PC case is fixed behind the monitor case with water-resistant gasket and flap hinge.

A special two-chamber solution is used to connect the cables. This way standard cables fitted with connectors can be used without disassemble.

### Properties

- Overall dimension: 500 x 425 x 132 mm
- IP65 casing (corrosion-resistant alloy steel, KOR)
- It can be recessed into panel cut or mounted on flat surface with foldable console
- Casing without fan or blow-hole

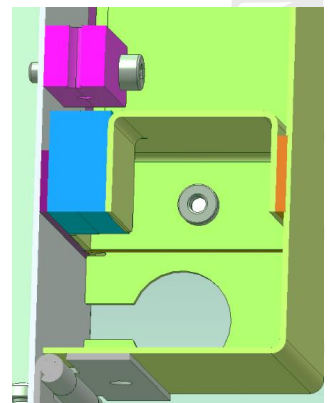

- Operating temperature: -25 – +50 °C
- 19", 4:3 ratio, HD high resolution monitor
- Capacitive touchscreen
- Brightness of the monitor: 250cd/m2
- Processor (CPU): i3-7100
- RAM memory: 4GB DDR4
- SSD memory: 240GB
- Ports:
  - 2xRS232,
  - 6xUSB2
  - Ethernet 100Mbit

### Mounting

The KP-1600E industrial PC can be recessed into a flat mounting plate. 436 x 350 mm cut is to be made. Retainer units can be ordered.

### Wall-mounting

Hinge plate is screwed to wall or mounting plate with the help of a drilling pattern. The display is pulled on the hinge plates like a door, then we close it and fix it with screw.

### Cable connection

Fold down the back part of the opened monitor, the computer case, plug up the cables, fix them, fold back and close the back part – the device is ready to operate.

The monitor can be replaced in the same manner.

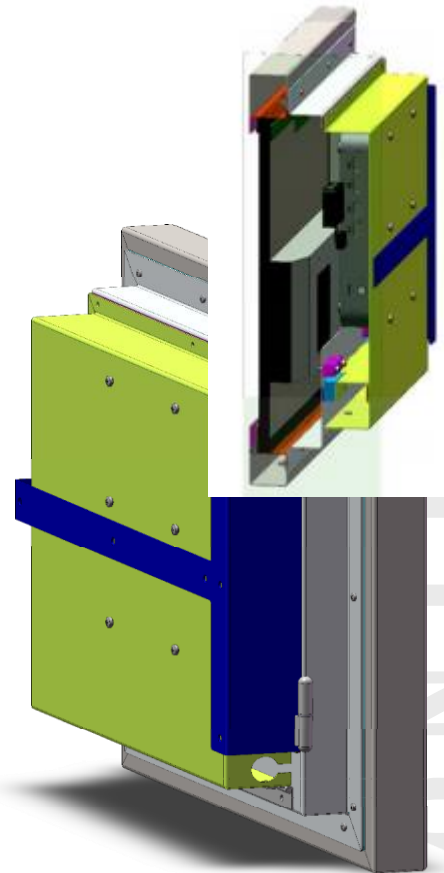

On the pictures below the KP-1600E can be seen in an open and closed way.

